

Straw Bale Village

The Straw Bale Village is the second village that will be built. It will demonstrate modularly expandable sustainable housing with a focus on families and family-oriented social and recreation spaces. This village features a large central theater space, playground, library, gym, computer room, 52 beautiful residential units, and more.

Estimated Square Feet: 30,000 sq ft (2,787 sq meters)



Apartment Section View
Showing entryway, downstairs studio living room, stairs to loft, bathroom

Housing for **110**

Recreation Space for **500**

34 Living/Resident Units

18 Visitor/Guest Units

Dining for **150+**

Laundry for **300**

11 Public Recreation Spaces

5 Group Meeting Spaces

17 Open Source Templates

Estimated Cost
\$2,557,000

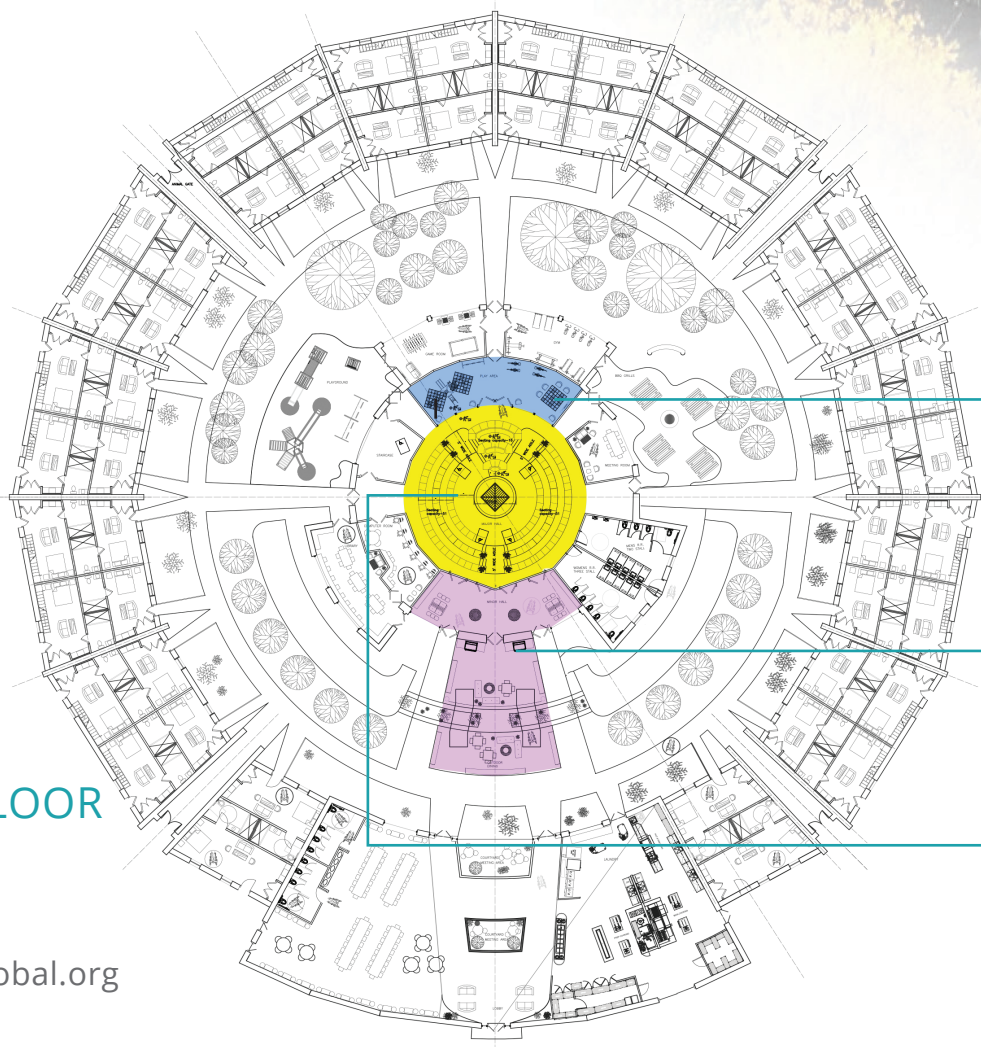

1ST FLOOR

Indoor Playroom



BBQ Area



Outdoor Areas



Central Theatre (Seating for 100+)



Outdoor Patio Balcony



Outdoor Pathways

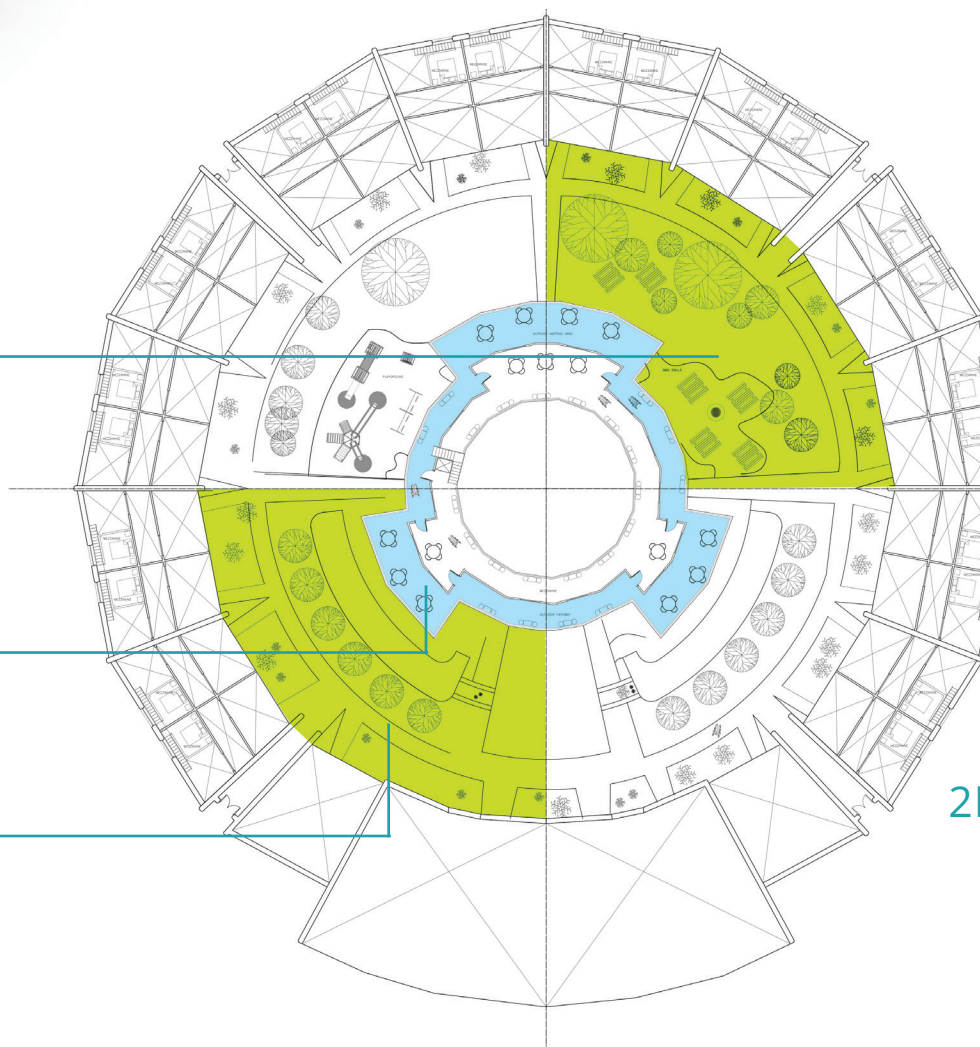

2ND FLOOR