

Just like with the City Center, all aspects of the Earthbag Village (and all other villages) are being open sourced specifically so others can easily replicate our designs or build their own creations using our designs for inspiration. The video tutorials, web-based tutorials, printable tutorials, ongoing FAQ updates, online problem solving guides, and database for sharing the implementations and evolutions of others will cover all structural details, plumbing, electrical, HVAC, installation, maintenance, materials acquisition, labor/time investment details, tools and equipment needs, licensing and permitting, and more. Here are some examples of this village's components included in this:

- View the Online Open Source Hub:
www.OneCommunityGlobal.org/Earthbag-Village



Video Tutorials



Web-Based Tutorials

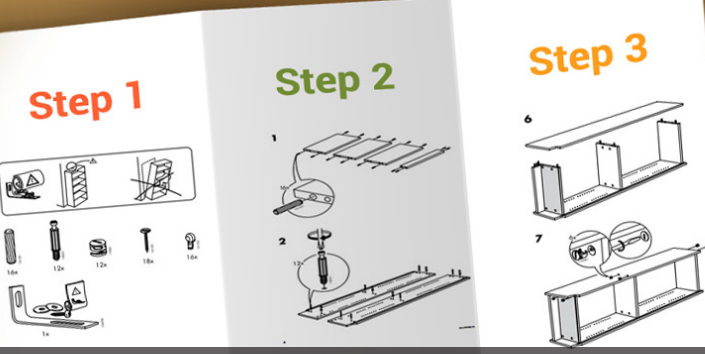

Printable Tutorials

Work Item	Labor	Equipment	Materials	Subcontr.	Subtotal
Permit Fees			\$500.00	\$1,500.00	\$1,500.00
Excavation	\$6,000.00	\$9,000.00			\$14,500.00
Utilities	\$3,500.00	\$2,500.00	\$2,750.00	\$1,000.00	\$9,750.00
Water Well					\$0.00
Septic Tank				\$3,500.00	\$3,500.00
Foundation				\$1,900.00	\$1,900.00
Concrete Flatwork			\$9,000.00		\$14,000.00
Framing	\$3,500.00	\$1,500.00		\$3,500.00	\$3,500.00
Roofing				\$9,000.00	\$9,000.00
Windows/Ext. Doors				\$2,250.00	\$2,250.00
Garage Door					
Siding				\$18,500.00	\$18,500.00
Electrical				\$16,500.00	\$16,500.00
Plumbing				\$23,000.00	\$23,000.00
HVAC			\$1,000.00		\$1,000.00

Materials Costs and Acquisition Guides



Labor Investment Experience Sharing



Custom Collaboration/Tracking Software

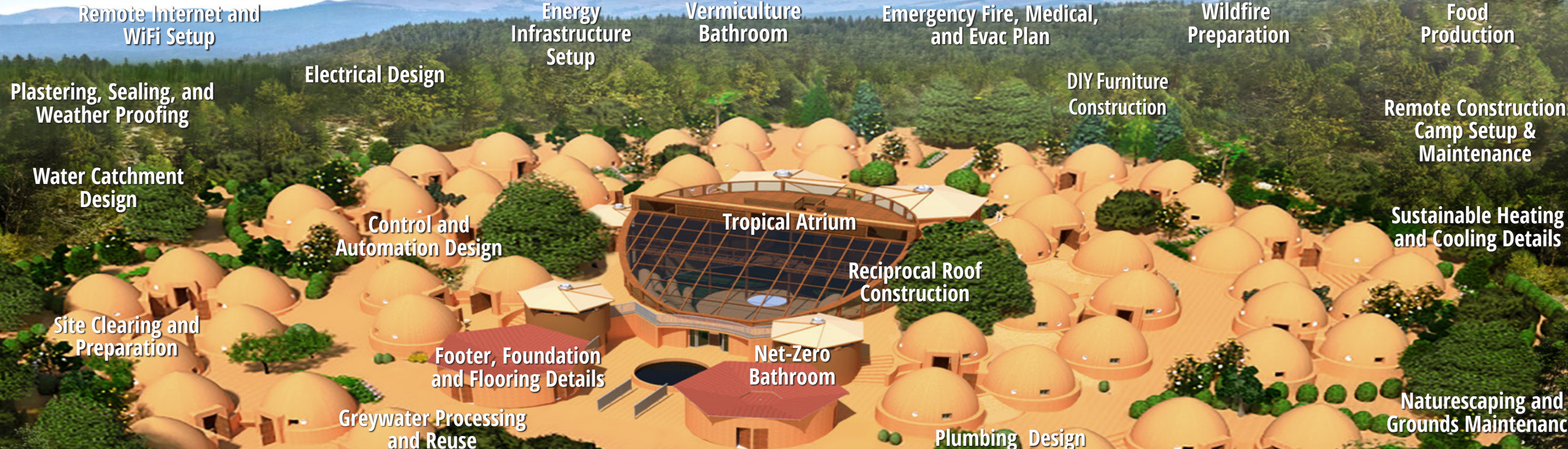

Database of Evolutions by Others

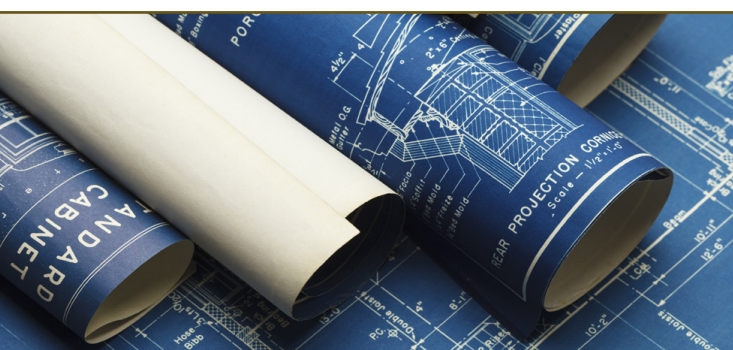

Licensing and Permitting Guides



Tools and Equipment-Needs Guides



Maintenance & Upkeep Hub



Multi-media Problem Solving Hub



Ongoing FAQ Database